

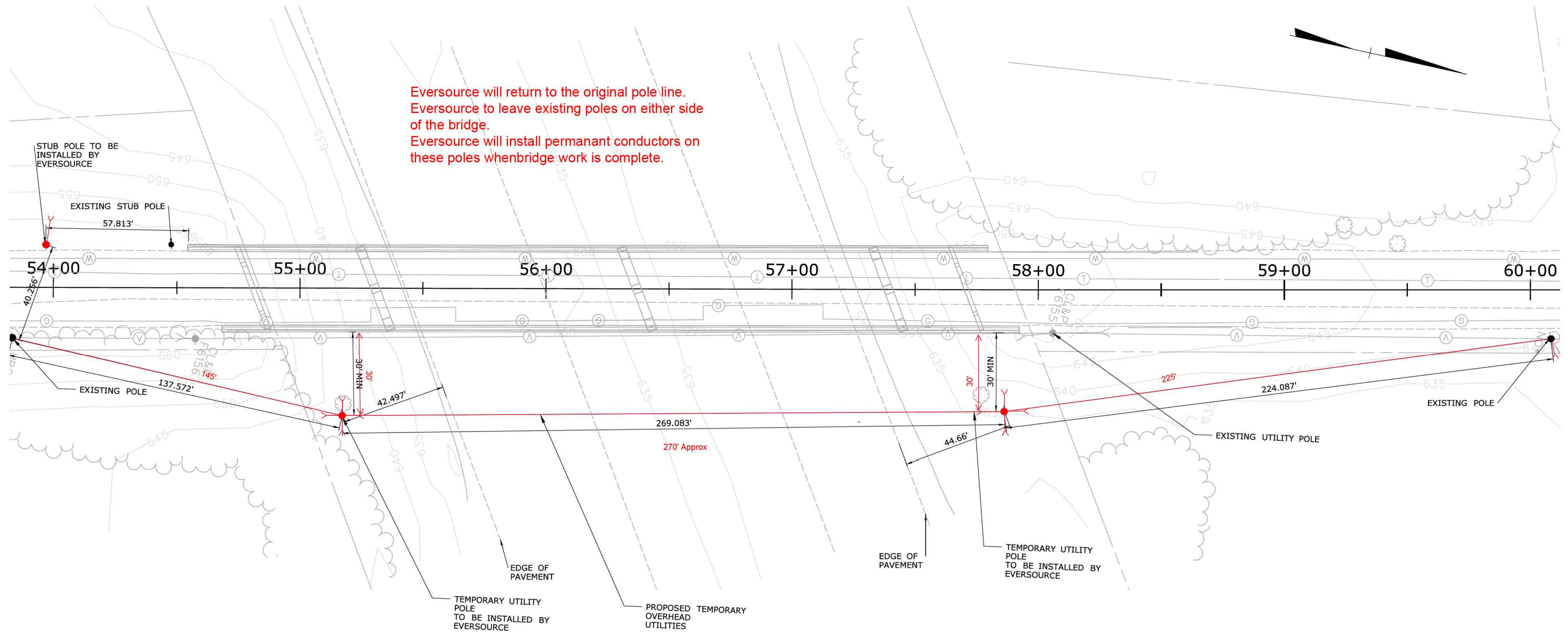

Eversource will return to the original pole line.  
 Eversource to leave existing poles on either side of the bridge.  
 Eversource will install permanent conductors on these poles when bridge work is complete.



**EVERSOURCE POLE RELOCATION**  
 SCALE: 1" = 20'

**FOR INFORMATION ONLY**

THE INFORMATION, INCLUDING ESTIMATED QUANTITIES OF WORK, SHOWN ON THESE SHEETS IS BASED ON LIMITED INVESTIGATIONS BY THE STATE AND IS IN NO WAY WARRANTED TO INDICATE THE CONDITIONS OF ACTUAL QUANTITIES OF WORK WHICH WILL BE REQUIRED.		DESIGNER/DRAFTER: CHECKED BY: SCALE AS NOTED	<b>STATE OF CONNECTICUT</b> <b>DEPARTMENT OF TRANSPORTATION</b> Filename: ...2020-04-20_0080-0131_POWER.dgn	SIGNATURE/BLOCK: <b>OFFICE OF ENGINEERING</b> APPROVED BY: 	PROJECT TITLE: <b>SUPERSTRUCTURE REPLACEMENT OF BRIDGE NO. 01160 BENSON ROAD OVER I-84</b>	TOWN: <b>MIDDLEBURY</b>	PROJECT NO. <b>0080-0131</b>
REV.	DATE	REVISION DESCRIPTION	SHEET NO.	Plotted Date: 6/9/2020	DRAWING TITLE: <b>RELOCATION PLAN</b>		DRAWING NO. <b>FIO-02</b>
							SHEET NO. <b>01.08.02</b>