



LEGEND:

-  FRONTIER UTILITY POLE
-  LED LUMINAIRE AND BRACKET BY EVERSOURCE:
92 WATT, 9,200 LUMEN (APPROXIMATE.), TYPE 3 LIGHT DISTRIBUTION,
3000°K, WITH PHOTO CELL.

NOTES:

- 1) ALL UTILITY WORK ASSOCIATED WITH THE STREET LIGHTING AS SHOWN ON THIS DRAWING SHALL BE PAID FOR UNDER THE ITEM: 1500006A - UTILITY ADJUSTMENT (ESTIMATED COST PLUS). ALL LIGHTING WORK SHALL BE PERFORMED BY EVERSOURCE OR UI AS INDICATED.
- 2) THE CONTRACTOR SHALL COORDINATE ALL EVERSOURCE WORK WITH MR. RICHARD RUSSO (203-245-5440) AND ALL UI WORK WITH MR. MICHAEL THERIAULT (203-499-2817).
- 3) THE CONTRACTOR SHALL CONTACT CTDOT FACILITIES ELECTRICAL DEPARTMENT MR. JOSEPH VETURIS (860-594-2756) IN STAGE 1 OF CONSTRUCTION TO INITIATE THE CUSTOMER REQUEST FOR SERVICE (CRS) AND MONTHLY ENERGY BILLING WITH EVERSOURCE (FOR TEMPORARY LIGHTING).
- 4) THE ILLUMINATION WORK SHOWN ON THIS PLAN IS TO BE CARRIED OUT DURING STAGE 2 OF CONSTRUCTION CONCURRENTLY WITH THE OVERHEAD UTILITY RELOCATION TO PROVIDE ILLUMINATION DURING STAGES 3 THROUGH 6.
- 5) THE CONTRACTOR SHALL COORDINATE WITH EVERSOURCE TO REMOVE THE EXISTING (TOWN LEASED) STREET LIGHTS FROM POLES FTR-168 AND FTR-2769. EVERSOURCE TO DISCONTINUE MONTHLY ENERGY COSTS BILLED TO THE TOWN OF GUILFORD FOR THESE STREET LIGHTS.

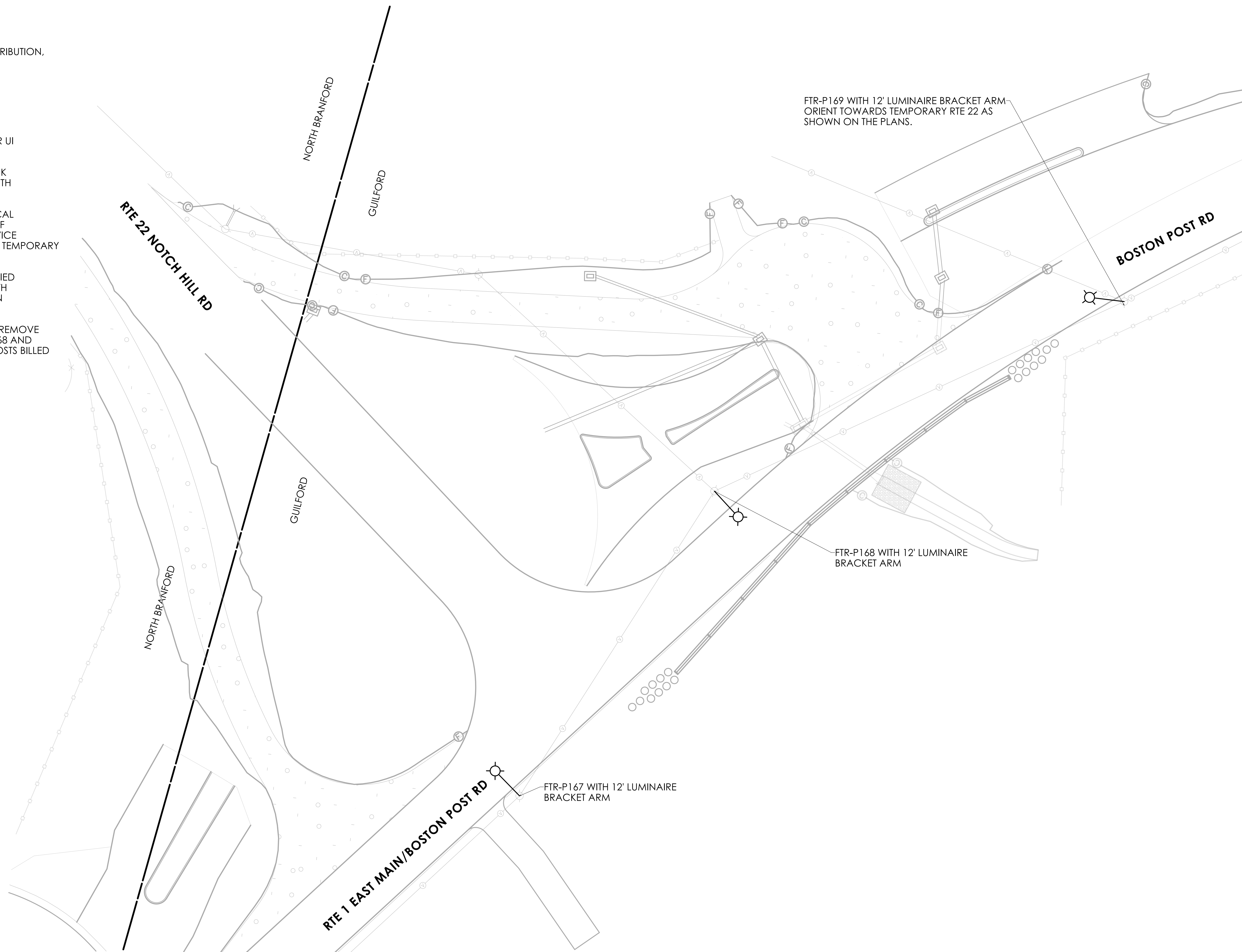

REV.	DATE	REVISION DESCRIPTION

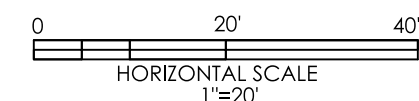

SIGNATURE/
BLOCK:

APPROVED BY:

OFFICE OF ENGINEERING
2800 BERLIN TURNPIKE
NEWINGTON, CT 06111



STATE OF CONNECTICUT
DEPARTMENT
OF
TRANSPORTATION



PROJECT NUMBER: 0059-0164

PROJECT DESCRIPTION: MODERN ROUNDABOUT AT U.S. ROUTE 1 AND ROUTE 22

TOWN(S): GUILFORD, BRANFORD, AND NORTH BRANFORD

DRAWING TITLE: TEMPORARY ILLUMINATION PLAN

DESIGNER/DRAFTER: JDV CHECKED BY: MSB
LASTED SAVED BY: Veturisd FILE NAME: P:\0059-0164\illumination\Sheet ILL-01.dgn
PLOTTED DATE: 1/30/2020

DRAWING NO.
ILL-02
SHEET NO.
05.02

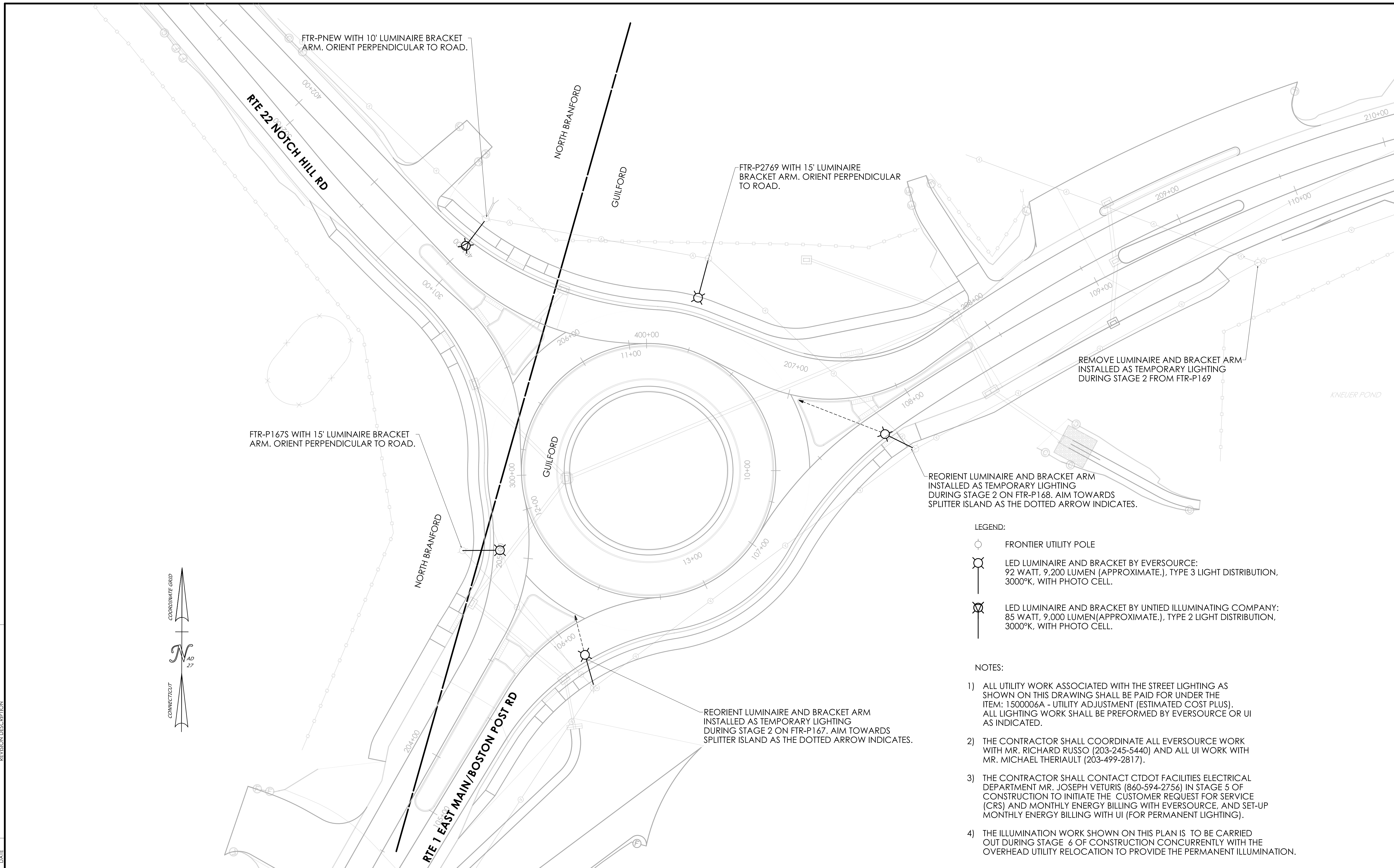

REV.	DATE	REVISION DESCRIPTION

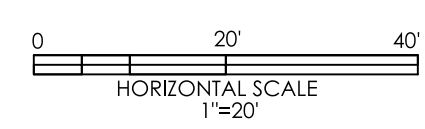

SIGNATURE/BLOCK: _____
 APPROVED BY: *Chapman*

OFFICE OF ENGINEERING
 2800 BERLIN TURNPIKE
 NEWINGTON, CT 06111

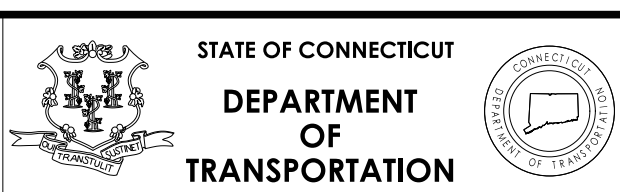

PROJECT NUMBER: 0059-0164
 PROJECT DESCRIPTION: MODERN ROUNDABOUT AT U.S. ROUTE 1 AND ROUTE 22
 TOWN(S): GUILFORD, BRANFORD, AND NORTH BRANFORD
 DRAWING TITLE: PERMANENT ILLUMINATION PLAN

DESIGNER/DRAFTER: JDV
 CHECKED BY: MSB
 LASTED SAVED BY: Veturisd
 FILE NAME: P:\0059-0164\illumination\Sheet ILL-02.dgn
 PLOTTED DATE: 1/30/2020

LEGEND:

- FRONTIER UTILITY POLE
- LED LUMINAIRE AND BRACKET BY EVERSOURCE:
92 WATT, 9,200 LUMEN (APPROXIMATE.), TYPE 3 LIGHT DISTRIBUTION, 3000°K, WITH PHOTO CELL.
- LED LUMINAIRE AND BRACKET BY UNTIED ILLUMINATING COMPANY:
85 WATT, 9,000 LUMEN (APPROXIMATE.), TYPE 2 LIGHT DISTRIBUTION, 3000°K, WITH PHOTO CELL.

NOTES:

- 1) ALL UTILITY WORK ASSOCIATED WITH THE STREET LIGHTING AS SHOWN ON THIS DRAWING SHALL BE PAID FOR UNDER THE ITEM: 1500006A - UTILITY ADJUSTMENT (ESTIMATED COST PLUS). ALL LIGHTING WORK SHALL BE PERFORMED BY EVERSOURCE OR UI AS INDICATED.
- 2) THE CONTRACTOR SHALL COORDINATE ALL EVERSOURCE WORK WITH MR. RICHARD RUSSO (203-245-5440) AND ALL UI WORK WITH MR. MICHAEL THERIAULT (203-499-2817).
- 3) THE CONTRACTOR SHALL CONTACT CTDOT FACILITIES ELECTRICAL DEPARTMENT MR. JOSEPH VETURIS (860-594-2756) IN STAGE 5 OF CONSTRUCTION TO INITIATE THE CUSTOMER REQUEST FOR SERVICE (CRS) AND MONTHLY ENERGY BILLING WITH EVERSOURCE, AND SET-UP MONTHLY ENERGY BILLING WITH UI (FOR PERMANENT LIGHTING).
- 4) THE ILLUMINATION WORK SHOWN ON THIS PLAN IS TO BE CARRIED OUT DURING STAGE 6 OF CONSTRUCTION CONCURRENTLY WITH THE OVERHEAD UTILITY RELOCATION TO PROVIDE THE PERMANENT ILLUMINATION.

DRAWING NO.
ILL-03
 SHEET NO.
05.03